

IS D360-120

Fixture Mount Occupancy Sensor



Project Name:
Location:



IS D360-120 Specifications

Item No.	65236
Voltage	120 VAC, 0-300 ballast or tungsten
Mounting	fixture mount or to listed enclosure
Sensing Technology	passive infrared (PIR)
Time Delay Setting	5 seconds to 20 minutes
Light Level Setting	.2-200 footcandles 2-2000 lux
Environment	IP20 rated, -4°F to +122°F, -20°C to +50°C
Coverage	360° with 180° angle of aperture, up to 13 ft (4 m) radial reach, up to 26 ft (8 m) tangential reach
Sensors	3 dual element infrared pyroelectric detectors
Lens Design	720 switching zones, 10 detection levels
Dimensions (LxWxD)	3.23 x 2.01 in 82 x 51 mm
Warranty	5 years
Certifications	C-UL-US Listed, RoHS Compliant, CA Compliant

The IS D360-120 is a fixture mount occupancy sensor for indoor use. The sensor's dimensions are the same as those of a MR16 lamp and fit commercially available MR16 fitting frames.

The sensor is passive infrared and responds to heat radiated from human body motion. They turn lighting ON automatically with occupancy or manually controlled using a wall switch. After a period of time where no occupancy has been detected, the sensor switches lighting OFF.

Applications

Fixture integrated for interior spaces such as offices, conference rooms, vestibules, and break rooms.

Key Features:

- 360° coverage with up to 13 ft (4 m) radial reach and 26 ft (8m) tangential reach
- Snap-on shrouds allow users to easily customize the coverage area
- 3 pyroelectric detectors with 720 switching zones provides highly accurate small motion detection
- Automatically adjusts to temperature changes keeping sensitivity and coverage consistent
- The hold off light level feature allows lighting to remain off during daylight regardless of occupancy

120 VAC

Voltage

PIR

Passive Infrared Technology



Coverage

IP20

IP20 Rated

Fixture
Mount

Mounting



www.steinell.net

IS D360-120

Fixture Mount Occupancy Sensor

Wiring

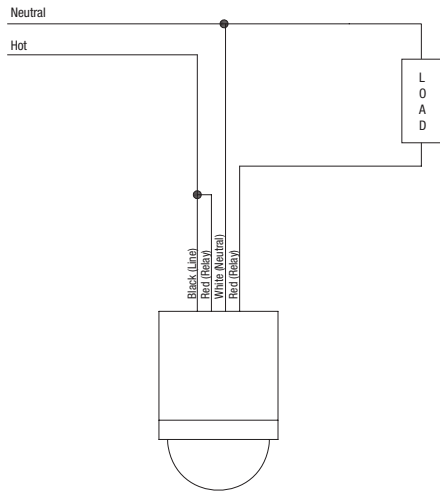

Coverage

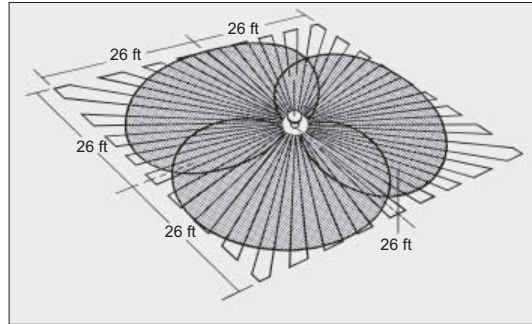

With a mounting height of 8 ft (2.5 m), the maximum reach of the sensor is 26 ft (8 m). Minor motion coverage, typical for an office environment, is 13 ft (4 m) radius. Coverage may vary depending on mounting height and environmental conditions.

Settings

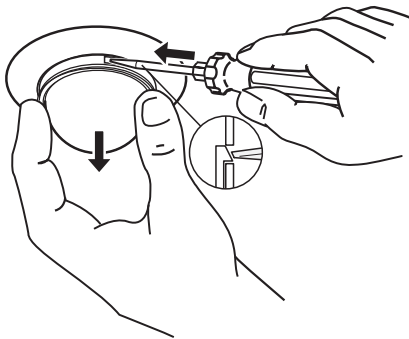

Light level and time delay settings are under the sensor module.

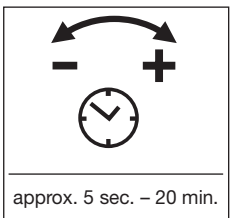
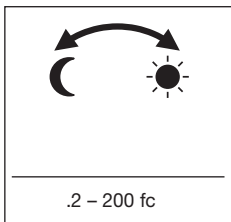

Coverage Adjustment

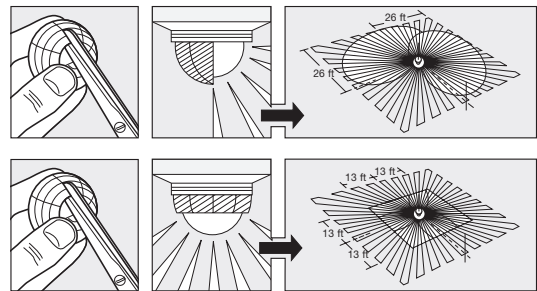

Mounting

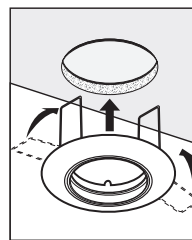

- 1 - Fitting frame
- 2 - Catch
- 3 - Switching module
- 4 - Sensor module
- 5 - Shroud
- 6 - Securing spring
- 7 - Light level setting
- 8 - Time delay setting

